

STATE	STATE PROJECT REFERENCE NO.	SHEET NO.	TOTAL SHEETS
N.C.	17BP.1.R.15 (360012)	1	9

**STATE OF NORTH CAROLINA  
DEPARTMENT OF TRANSPORTATION  
DIVISION OF HIGHWAYS  
GEOTECHNICAL ENGINEERING UNIT**

**STRUCTURE  
SUBSURFACE INVESTIGATION**

PROJ. REFERENCE NO. 17BP.1.R.15 (360012) F.A. PROJ. NA  
 COUNTY GATES  
 PROJECT DESCRIPTION BRIDGE NO. 360012 ON NC 137 OVER COLE CREEK

**CONTENTS**

<u>SHEET</u>	<u>DESCRIPTION</u>
1	TITLE SHEET
2 - 2A	LEGEND
3	SITE PLAN
4 - 9	BORING LOGS

PERSONNEL

M. BACHMAN

A. LOFTIN

TRIGON LLC

INVESTIGATED BY D. CARR  
 CHECKED BY P. ZHANG  
 SUBMITTED BY P. ZHANG  
 DATE MAY 2012

**CAUTION NOTICE**

THE SUBSURFACE INFORMATION AND THE SUBSURFACE INVESTIGATION ON WHICH IT IS BASED WERE MADE FOR THE PURPOSE OF STUDY, PLANNING, AND DESIGN, AND NOT FOR CONSTRUCTION OR PAY PURPOSES. THE VARIOUS FIELD BORING LOGS, ROCK CORES, AND SOIL TEST DATA AVAILABLE MAY BE REVIEWED OR INSPECTED IN RALEIGH BY CONTACTING THE N.C. DEPARTMENT OF TRANSPORTATION, GEOTECHNICAL ENGINEERING UNIT AT (919) 707-6850. NEITHER THE SUBSURFACE PLANS AND REPORTS, NOR THE FIELD BORING LOGS, ROCK CORES, OR SOIL TEST DATA ARE PART OF THE CONTRACT.

GENERAL SOIL AND ROCK STRATA DESCRIPTIONS AND INDICATED BOUNDARIES ARE BASED ON A GEOTECHNICAL INTERPRETATION OF ALL AVAILABLE SUBSURFACE DATA AND MAY NOT NECESSARILY REFLECT THE ACTUAL SUBSURFACE CONDITIONS BETWEEN BORINGS OR BETWEEN SAMPLED STRATA WITHIN THE BOREHOLE. THE LABORATORY SAMPLE DATA AND THE IN SITU (IN-PLACE) TEST DATA CAN BE RELIED ON ONLY TO THE DEGREE OF RELIABILITY INHERENT IN THE STANDARD TEST METHOD. THE OBSERVED WATER LEVELS OR SOIL MOISTURE CONDITIONS INDICATED IN THE SUBSURFACE INVESTIGATIONS ARE AS RECORDED AT THE TIME OF THE INVESTIGATION. THESE WATER LEVELS OR SOIL MOISTURE CONDITIONS MAY VARY CONSIDERABLY WITH TIME ACCORDING TO CLIMATIC CONDITIONS INCLUDING TEMPERATURES, PRECIPITATION, AND WIND, AS WELL AS OTHER NON-CLIMATIC FACTORS.

THE BIDDER OR CONTRACTOR IS CAUTIONED THAT DETAILS SHOWN ON THE SUBSURFACE PLANS ARE PRELIMINARY ONLY AND IN MANY CASES THE FINAL DESIGN DETAILS ARE DIFFERENT. FOR BIDDING AND CONSTRUCTION PURPOSES, REFER TO THE CONSTRUCTION PLANS AND DOCUMENTS FOR FINAL DESIGN INFORMATION ON THIS PROJECT. THE DEPARTMENT DOES NOT WARRANT OR GUARANTEE THE SUFFICIENCY OR ACCURACY OF THE INVESTIGATION MADE, NOR THE INTERPRETATIONS MADE, OR OPINION OF THE DEPARTMENT AS TO THE TYPE OF MATERIALS AND CONDITIONS TO BE ENCOUNTERED. THE BIDDER OR CONTRACTOR IS CAUTIONED TO MAKE SUCH INDEPENDENT SUBSURFACE INVESTIGATIONS AS HE DEEMS NECESSARY TO SATISFY HIMSELF AS TO CONDITIONS TO BE ENCOUNTERED ON THIS PROJECT. THE CONTRACTOR SHALL HAVE NO CLAIM FOR ADDITIONAL COMPENSATION OR FOR AN EXTENSION OF TIME FOR ANY REASON RESULTING FROM THE ACTUAL CONDITIONS ENCOUNTERED AT THE SITE DIFFERING FROM THOSE INDICATED IN THE SUBSURFACE INFORMATION.

NOTE - THE INFORMATION CONTAINED HEREIN IS NOT IMPLIED OR GUARANTEED BY THE N. C. DEPARTMENT OF TRANSPORTATION AS BEING ACCURATE NOR IT IS CONSIDERED TO BE PART OF THE PLANS, SPECIFICATIONS, OR CONTRACT FOR THE PROJECT.

NOTE - BY HAVING REQUESTED THIS INFORMATION THE CONTRACTOR SPECIFICALLY WAIVES ANY CLAIMS FOR INCREASED COMPENSATION OR EXTENSION OF TIME BASED ON DIFFERENCES BETWEEN THE CONDITIONS INDICATED HEREIN AND THE ACTUAL CONDITIONS AT THE PROJECT SITE.

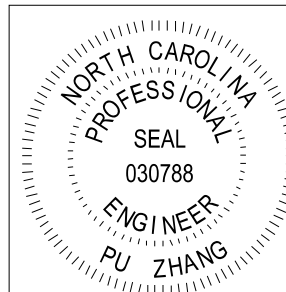

*[Signature]*  
5-28-12  
SIGNATURE

DRAWN BY: S. CROCKETT

**NORTH CAROLINA DEPARTMENT OF TRANSPORTATION  
DIVISION OF HIGHWAYS  
GEOTECHNICAL ENGINEERING UNIT  
SOIL AND ROCK LEGEND, TERMS, SYMBOLS, AND ABBREVIATIONS**

SOIL DESCRIPTION										GRADATION									
SOIL IS CONSIDERED TO BE THE UNCONSOLIDATED, SEMI-CONSOLIDATED, OR WEATHERED EARTH MATERIALS THAT CAN BE PENETRATED WITH A CONTINUOUS FLIGHT POWER AUGER, AND YIELD LESS THAN 100 BLOWS PER FOOT ACCORDING TO STANDARD PENETRATION TEST (AASHTO T206, ASTM D-1586). SOIL CLASSIFICATION IS BASED ON THE AASHTO SYSTEM. BASIC DESCRIPTIONS GENERALLY SHALL INCLUDE: CONSISTENCY, COLOR, TEXTURE, MOISTURE, AASHTO CLASSIFICATION, AND OTHER PERTINENT FACTORS SUCH AS MINERALOGICAL COMPOSITION, ANGULARITY, STRUCTURE, PLASTICITY, ETC. EXAMPLE: <i>VERY STIFF, GRN, SILTY CLAY, MOST WITH INTERBEDDED FINE SAND LAYERS, HIGHLY PLASTIC, A-7-6</i>										WELL GRADED - INDICATES A GOOD REPRESENTATION OF PARTICLE SIZES FROM FINE TO COARSE. UNIFORM - INDICATES THAT SOIL PARTICLES ARE ALL APPROXIMATELY THE SAME SIZE. (ALSO POORLY GRADED) GAP-GRADED - INDICATES A MIXTURE OF UNIFORM PARTICLES OF TWO OR MORE SIZES.									
										ANGULARITY OF GRAINS									
SOIL LEGEND AND AASHTO CLASSIFICATION										MINERALOGICAL COMPOSITION									
GENERAL CLASS. GRANULAR MATERIALS (<= 35% PASSING #200) SILT-CLAY MATERIALS (> 35% PASSING #200) ORGANIC MATERIALS										MINERAL NAMES SUCH AS QUARTZ, FELDSPAR, MICA, TALC, KAOLIN, ETC. ARE USED IN DESCRIPTIONS WHENEVER THEY ARE CONSIDERED OF SIGNIFICANCE.									
GROUP CLASS. A-1 A-3 A-2 A-4 A-5 A-6 A-7 A-1, A-2 A-3 A-4, A-5 A-6, A-7										COMPRESSIBILITY									
SYMBOL										SLIGHTLY COMPRESSIBLE LIQUID LIMIT LESS THAN 31 MODERATELY COMPRESSIBLE LIQUID LIMIT EQUAL TO 31-50 HIGHLY COMPRESSIBLE LIQUID LIMIT GREATER THAN 50									
% PASSING # 10 50 MX 30 MX 50 MX 51 MN 10 MX 35 MX 35 MX 35 MX 35 MX 36 MN 36 MN 36 MN 36 MN # 40 15 MX 25 MX 10 MX 10 MX 10 MX 11 MN 11 MN 10 MX 10 MX 11 MN 11 MN # 200 15 MX 25 MX 10 MX 10 MX 10 MX 11 MN 11 MN 10 MX 10 MX 11 MN 11 MN										PERCENTAGE OF MATERIAL									
LIQUID LIMIT PLASTIC INDEX 6 MX NP 40 MX 41 MN 40 MX 41 MN 40 MX 41 MN 40 MX 41 MN 40 MX 41 MN 40 MX 41 MN										ORGANIC MATERIAL GRANULAR SILT - CLAY OTHER MATERIAL TRACE OF ORGANIC MATTER 2 - 3% 3 - 5% TRACE 1 - 10% LITTLE ORGANIC MATTER 3 - 5% 5 - 12% LITTLE 10 - 20% MODERATELY ORGANIC 5 - 10% 12 - 20% SOME 20 - 35% HIGHLY ORGANIC >10% >20% HIGHLY 35% AND ABOVE									
GROUP INDEX 0 0 0 4 MX 8 MX 12 MX 16 MX No MX										GROUND WATER									
USUAL TYPES OF MAJOR MATERIALS STONE FRAGS, GRAVEL, AND SAND FINE SAND SILTY OR CLAYEY GRAVEL AND SAND SILTY SOILS CLAYEY SOILS										WATER LEVEL IN BORE HOLE IMMEDIATELY AFTER DRILLING STATIC WATER LEVEL AFTER 24 HOURS PERCHED WATER, SATURATED ZONE, OR WATER BEARING STRATA SPRING OR SEEP									
GEN. RATING AS A SUBGRADE EXCELLENT TO GOOD FAIR TO POOR FAIR TO POOR POOR UNSUITABLE										MISCELLANEOUS SYMBOLS									
PI OF A-7-5 SUBGROUP IS <= LL - 30 ; PI OF A-7-6 SUBGROUP IS > LL - 30										ROADWAY EMBANKMENT (RE) WITH SOIL DESCRIPTION SOIL SYMBOL ARTIFICIAL FILL (AF) OTHER THAN ROADWAY EMBANKMENT INFERRED SOIL BOUNDARY INFERRED ROCK LINE ALLUVIAL SOIL BOUNDARY DIP & DIP DIRECTION OF ROCK STRUCTURES									
CONSISTENCY OR DENSENESS										SPT DMT VST PMT TEST BORING TEST BORING W/ CORE AUGER BORING CORE BORING MONITORING WELL PIEZOMETER INSTALLATION SLOPE INDICATOR INSTALLATION CONE PENETROMETER TEST SOUNDING ROD									
PRIMARY SOIL TYPE COMPACTNESS OR CONSISTENCY RANGE OF STANDARD PENETRATION RESISTANCE (N-VALUE) RANGE OF UNCONFINED COMPRESSIVE STRENGTH (TONS/F <sup>2</sup> )										GENERALLY GRANULAR MATERIAL (NON-COHESIVE) VERY LOOSE 4 TO 10 MEDIUM DENSE 10 TO 30 DENSE 30 TO 50 VERY DENSE >50 GENERALLY SILT-CLAY MATERIAL (COHESIVE) VERY SOFT 2 TO 4 SOFT 4 TO 8 MEDIUM STIFF 8 TO 15 STIFF 15 TO 30 VERY STIFF >30									
TEXTURE OR GRAIN SIZE										ABBREVIATIONS									
U.S. STD. SIEVE SIZE OPENING (MM) 4 10 40 60 200 270 4.76 2.00 0.42 0.25 0.075 0.053										AR - AUGER REFUSAL MED. - MEDIUM BT - BORING TERMINATED MICA - MICACEOUS CL. - CLAY MOD. - MODERATELY CPT - CONE PENETRATION TEST NP - NON PLASTIC CSE. - COARSE ORG. - ORGANIC DMT - DILATOMETER TEST PMT - PRESSUREMETER TEST DPT - DYNAMIC PENETRATION TEST SAP. - SAPROLITIC e - VOID RATIO SD. - SAND, SANDY F - FINE SL. - SILT, SILTY FOSS. - FOSSILIFEROUS SLLI - SLIGHTLY FRAC. - FRACTURED, FRACTURES TCR - TRICONE REFUSAL FRAGS. - FRAGMENTS w - MOISTURE CONTENT HI. - HIGHLY V - VERY									
BOULDER (BLDR.) COBBLE (COB.) GRAVEL (GR.) COARSE SAND (CSE. SD.) FINE SAND (F SD.) SILT (SL.) CLAY (CL.)										SAMPLE ABBREVIATIONS									
GRAIN SIZE MM 305 75 2.0 0.25 0.05 0.005 IN. 12 3										S - BULK SS - SPLIT SPOON ST - SHELBY TUBE RS - ROCK RT - RECOMPACTED TRIAXIAL CBR - CALIFORNIA BEARING RATIO									
SOIL MOISTURE - CORRELATION OF TERMS										EQUIPMENT USED ON SUBJECT PROJECT									
SOIL MOISTURE SCALE (ATTERBERG LIMITS) FIELD MOISTURE DESCRIPTION GUIDE FOR FIELD MOISTURE DESCRIPTION										DRILL UNITS: MOBILE B- BK-51 CME-45C CME-550 PORTABLE HOIST CME-55 ADVANCING TOOLS: CLAY BITS 6" CONTINUOUS FLIGHT AUGER 8" HOLLOW AUGERS HARD FACED FINGER BITS TUNG-CARBIDE INSERTS CASING w/ ADVANCER TRICONE STEEL TEETH TRICONE TUNG-CARB. CORE BIT MUD ROTARY HAMMER TYPE: AUTOMATIC MANUAL CORE SIZE: B N H HAND TOOLS: POST HOLE DIGGER HAND AUGER SOUNDING ROD VANE SHEAR TEST									
LL LIQUID LIMIT - SATURATED - (SAT.) USUALLY LIQUID; VERY WET, USUALLY FROM BELOW THE GROUND WATER TABLE PLASTIC RANGE (PI) PL PLASTIC LIMIT - WET - (W) SEMISOLID; REQUIRES DRYING TO ATTAIN OPTIMUM MOISTURE OM OPTIMUM MOISTURE - MOIST - (M) SOLID; AT OR NEAR OPTIMUM MOISTURE SL SHRINKAGE LIMIT - DRY - (D) REQUIRES ADDITIONAL WATER TO ATTAIN OPTIMUM MOISTURE										PLASTICITY									
NONPLASTIC 0-5 VERY LOW LOW PLASTICITY 6-15 SLIGHT MED. PLASTICITY 16-25 MEDIUM HIGH PLASTICITY 26 OR MORE HIGH										COLOR									
DESCRIPTIONS MAY INCLUDE COLOR OR COLOR COMBINATIONS (TAN, RED, YELLOW-BROWN, BLUE-GRAY). MODIFIERS SUCH AS LIGHT, DARK, STREAKED, ETC. ARE USED TO DESCRIBE APPEARANCE.																			

**NORTH CAROLINA DEPARTMENT OF TRANSPORTATION  
DIVISION OF HIGHWAYS  
GEOTECHNICAL ENGINEERING UNIT  
SOIL AND ROCK LEGEND, TERMS, SYMBOLS, AND ABBREVIATIONS**

ROCK DESCRIPTION		TERMS AND DEFINITIONS																											
<p>HARD ROCK IS NON-COASTAL PLAIN MATERIAL THAT IF TESTED, WOULD YIELD SPT REFUSAL. AN INFERRED ROCK LINE INDICATES THE LEVEL AT WHICH NON-COASTAL PLAIN MATERIAL WOULD YIELD SPT REFUSAL. SPT REFUSAL IS PENETRATION BY A SPLIT SPOON SAMPLER EQUAL TO OR LESS THAN 0.1 FOOT PER 60 BLOWS. IN NON-COASTAL PLAIN MATERIAL, THE TRANSITION BETWEEN SOIL AND ROCK IS OFTEN REPRESENTED BY A ZONE OF WEATHERED ROCK. ROCK MATERIALS ARE TYPICALLY DIVIDED AS FOLLOWS:</p>		<p><b>ALLUVIUM (ALLUV.)</b> - SOILS THAT HAVE BEEN TRANSPORTED BY WATER.  <b>AQUIFER</b> - A WATER BEARING FORMATION OR STRATA.  <b>ARENACEOUS</b> - APPLIED TO ROCKS THAT HAVE BEEN DERIVED FROM SAND OR THAT CONTAIN SAND.  <b>ARGILLACEOUS</b> - APPLIED TO ALL ROCKS OR SUBSTANCES COMPOSED OF CLAY MINERALS, OR HAVING A NOTABLE PROPORTION OF CLAY IN THEIR COMPOSITION, AS SHALE, SLATE, ETC.  <b>ARTESIAN</b> - GROUND WATER THAT IS UNDER SUFFICIENT PRESSURE TO RISE ABOVE THE LEVEL AT WHICH IT IS ENCOUNTERED, BUT WHICH DOES NOT NECESSARILY RISE TO OR ABOVE THE GROUND SURFACE.  <b>CALCAREOUS (CALC.)</b> - SOILS THAT CONTAIN APPRECIABLE AMOUNTS OF CALCIUM CARBONATE.  <b>COLLUVIUM</b> - ROCK FRAGMENTS MIXED WITH SOIL DEPOSITED BY GRAVITY ON SLOPE OR AT BOTTOM OF SLOPE.  <b>CORE RECOVERY (REC.)</b> - TOTAL LENGTH OF ALL MATERIAL RECOVERED IN THE CORE BARREL DIVIDED BY TOTAL LENGTH OF CORE RUN AND EXPRESSED AS A PERCENTAGE.  <b>DIKE</b> - A TABULAR BODY OF IGNEOUS ROCK THAT CUTS ACROSS THE STRUCTURE OF ADJACENT ROCKS OR CUTS MASSIVE ROCK.  <b>DIP</b> - THE ANGLE AT WHICH A STRATUM OR ANY PLANAR FEATURE IS INCLINED FROM THE HORIZONTAL.  <b>DIP DIRECTION (DIP AZIMUTH)</b> - THE DIRECTION OR BEARING OF THE HORIZONTAL TRACE OF THE LINE OF DIP, MEASURED CLOCKWISE FROM NORTH.  <b>FAULT</b> - A FRACTURE OR FRACTURE ZONE ALONG WHICH THERE HAS BEEN DISPLACEMENT OF THE SIDES RELATIVE TO ONE ANOTHER PARALLEL TO THE FRACTURE.  <b>FISSILE</b> - A PROPERTY OF SPLITTING ALONG CLOSELY SPACED PARALLEL PLANES.  <b>FLOAT</b> - ROCK FRAGMENTS ON SURFACE NEAR THEIR ORIGINAL POSITION AND DISLOGGED FROM PARENT MATERIAL.  <b>FLOOD PLAIN (FP)</b> - LAND BORDERING A STREAM, BUILT OF SEDIMENTS DEPOSITED BY THE STREAM.  <b>FORMATION (FM.)</b> - A MAPPABLE GEOLOGIC UNIT THAT CAN BE RECOGNIZED AND TRACED IN THE FIELD.  <b>JOINT</b> - FRACTURE IN ROCK ALONG WHICH NO APPRECIABLE MOVEMENT HAS OCCURRED.  <b>LEDGE</b> - A SHELF-LIKE RIDGE OR PROJECTION OF ROCK WHOSE THICKNESS IS SMALL COMPARED TO ITS LATERAL EXTENT.  <b>LENS</b> - A BODY OF SOIL OR ROCK THAT THINS OUT IN ONE OR MORE DIRECTIONS.  <b>MOTTLED (MOT.)</b> - IRREGULARLY MARKED WITH SPOTS OF DIFFERENT COLORS. MOTTLING IN SOILS USUALLY INDICATES POOR AERATION AND LACK OF GOOD DRAINAGE.  <b>PERCHED WATER</b> - WATER MAINTAINED ABOVE THE NORMAL GROUND WATER LEVEL BY THE PRESENCE OF AN INTERVENING IMPERVIOUS STRATUM.  <b>RESIDUAL (RES.) SOIL</b> - SOIL FORMED IN PLACE BY THE WEATHERING OF ROCK.  <b>ROCK QUALITY DESIGNATION (ROD)</b> - A MEASURE OF ROCK QUALITY DESCRIBED BY TOTAL LENGTH OF ROCK SEGMENTS EQUAL TO OR GREATER THAN 4 INCHES DIVIDED BY THE TOTAL LENGTH OF CORE RUN AND EXPRESSED AS A PERCENTAGE.  <b>SAPROLITE (SAP.)</b> - RESIDUAL SOIL THAT RETAINS THE RELIC STRUCTURE OR FABRIC OF THE PARENT ROCK.  <b>SILL</b> - AN INTRUSIVE BODY OF IGNEOUS ROCK OF APPROXIMATELY UNIFORM THICKNESS AND RELATIVELY THIN COMPARED WITH ITS LATERAL EXTENT, THAT HAS BEEN EMPLACED PARALLEL TO THE BEDDING OR SCHISTOSITY OF THE INTRUDED ROCKS.  <b>SLICKENSIDE</b> - POLISHED AND STRIATED SURFACE THAT RESULTS FROM FRICTION ALONG A FAULT OR SLIP PLANE.  <b>STANDARD PENETRATION TEST (PENETRATION RESISTANCE) (SPT)</b> - NUMBER OF BLOWS (N OR BPF) OF A 140 LB. HAMMER FALLING 30 INCHES REQUIRED TO PRODUCE A PENETRATION OF 1 FOOT INTO SOIL WITH A 2 INCH OUTSIDE DIAMETER SPLIT SPOON SAMPLER. SPT REFUSAL IS PENETRATION EQUAL TO OR LESS THAN 0.1 FOOT PER 60 BLOWS.  <b>STRATA CORE RECOVERY (SREC.)</b> - TOTAL LENGTH OF STRATA MATERIAL RECOVERED DIVIDED BY TOTAL LENGTH OF STRATUM AND EXPRESSED AS A PERCENTAGE.  <b>STRATA ROCK QUALITY DESIGNATION (SROD)</b> - A MEASURE OF ROCK QUALITY DESCRIBED BY TOTAL LENGTH OF ROCK SEGMENTS WITHIN A STRATUM EQUAL TO OR GREATER THAN 4 INCHES DIVIDED BY THE TOTAL LENGTH OF STRATA AND EXPRESSED AS A PERCENTAGE.  <b>TOPSOIL (TS.)</b> - SURFACE SOILS USUALLY CONTAINING ORGANIC MATTER.</p>																											
<p><b>WEATHERED ROCK (WR)</b></p> 	<p>NON-COASTAL PLAIN MATERIAL THAT WOULD YIELD SPT N VALUES &gt; 100 BLOWS PER FOOT IF TESTED.</p>																												
<p><b>CRYSTALLINE ROCK (CR)</b></p> 	<p>FINE TO COARSE GRAIN IGNEOUS AND METAMORPHIC ROCK THAT WOULD YIELD SPT REFUSAL IF TESTED. ROCK TYPE INCLUDES GRANITE, GNEISS, GABBRO, SCHIST, ETC.</p>																												
<p><b>NON-CRYSTALLINE ROCK (NCR)</b></p> 	<p>FINE TO COARSE GRAIN METAMORPHIC AND NON-COASTAL PLAIN SEDIMENTARY ROCK THAT WOULD YIELD SPT REFUSAL IF TESTED. ROCK TYPE INCLUDES PHYLLITE, SLATE, SANDSTONE, ETC.</p>																												
<p><b>COASTAL PLAIN SEDIMENTARY ROCK (CP)</b></p> 	<p>COASTAL PLAIN SEDIMENTS CEMENTED INTO ROCK, BUT MAY NOT YIELD SPT REFUSAL. ROCK TYPE INCLUDES LIMESTONE, SANDSTONE, CEMENTED SHELL BEDS, ETC.</p>																												
WEATHERING																													
<p><b>FRESH</b></p>	<p>ROCK FRESH, CRYSTALS BRIGHT, FEW JOINTS MAY SHOW SLIGHT STAINING. ROCK RINGS UNDER HAMMER IF CRYSTALLINE.</p>																												
<p><b>VERY SLIGHT (V SL.)</b></p>	<p>ROCK GENERALLY FRESH, JOINTS STAINED, SOME JOINTS MAY SHOW THIN CLAY COATINGS IF OPEN, CRYSTALS ON A BROKEN SPECIMEN FACE SHINE BRIGHTLY. ROCK RINGS UNDER HAMMER BLOWS IF OF A CRYSTALLINE NATURE.</p>																												
<p><b>SLIGHT (SL.)</b></p>	<p>ROCK GENERALLY FRESH, JOINTS STAINED AND DISCOLORATION EXTENDS INTO ROCK UP TO 1 INCH. OPEN JOINTS MAY CONTAIN CLAY. IN GRANITOID ROCKS SOME OCCASIONAL FELDSPAR CRYSTALS ARE DULL AND DISCOLORED. CRYSTALLINE ROCKS RING UNDER HAMMER BLOWS.</p>																												
<p><b>MODERATE (MOD.)</b></p>	<p>SIGNIFICANT PORTIONS OF ROCK SHOW DISCOLORATION AND WEATHERING EFFECTS. IN GRANITOID ROCKS, MOST FELDSPARS ARE DULL AND DISCOLORED, SOME SHOW CLAY. ROCK HAS DULL SOUND UNDER HAMMER BLOWS AND SHOWS SIGNIFICANT LOSS OF STRENGTH AS COMPARED WITH FRESH ROCK.</p>																												
<p><b>MODERATELY SEVERE (MOD. SEV.)</b></p>	<p>ALL ROCK EXCEPT QUARTZ DISCOLORED OR STAINED. IN GRANITOID ROCKS, ALL FELDSPARS DULL AND DISCOLORED AND A MAJORITY SHOW KAOLINIZATION. ROCK SHOWS SEVERE LOSS OF STRENGTH AND CAN BE EXCAVATED WITH A GEOLOGIST'S PICK. ROCK GIVES "CLUNK" SOUND WHEN STRUCK. <i>IF TESTED, WOULD YIELD SPT REFUSAL</i></p>																												
<p><b>SEVERE (SEV.)</b></p>	<p>ALL ROCK EXCEPT QUARTZ DISCOLORED OR STAINED. ROCK FABRIC CLEAR AND EVIDENT BUT REDUCED IN STRENGTH TO STRONG SOIL. IN GRANITOID ROCKS ALL FELDSPARS ARE KAOLINIZED TO SOME EXTENT. SOME FRAGMENTS OF STRONG ROCK USUALLY REMAIN. <i>IF TESTED, YIELDS SPT N VALUES &gt; 100 BPF</i></p>																												
<p><b>VERY SEVERE (V SEV.)</b></p>	<p>ALL ROCK EXCEPT QUARTZ DISCOLORED OR STAINED. ROCK FABRIC ELEMENTS ARE DISCERNIBLE BUT THE MASS IS EFFECTIVELY REDUCED TO SOIL STATUS, WITH ONLY FRAGMENTS OF STRONG ROCK REMAINING. SAPROLITE IS AN EXAMPLE OF ROCK WEATHERED TO A DEGREE SUCH THAT ONLY MINOR VESTIGES OF THE ORIGINAL ROCK FABRIC REMAIN. <i>IF TESTED, YIELDS SPT N VALUES 100 BPF</i></p>																												
<p><b>COMPLETE</b></p>	<p>ROCK REDUCED TO SOIL. ROCK FABRIC NOT DISCERNIBLE, OR DISCERNIBLE ONLY IN SMALL AND SCATTERED CONCENTRATIONS. QUARTZ MAY BE PRESENT AS DIKES OR STRINGERS. SAPROLITE IS ALSO AN EXAMPLE.</p>																												
ROCK HARDNESS																													
<p><b>VERY HARD</b></p>	<p>CANNOT BE SCRATCHED BY KNIFE OR SHARP PICK. BREAKING OF HAND SPECIMENS REQUIRES SEVERAL HARD BLOWS OF THE GEOLOGIST'S PICK.</p>																												
<p><b>HARD</b></p>	<p>CAN BE SCRATCHED BY KNIFE OR PICK ONLY WITH DIFFICULTY. HARD HAMMER BLOWS REQUIRED TO DETACH HAND SPECIMEN.</p>																												
<p><b>MODERATELY HARD</b></p>	<p>CAN BE SCRATCHED BY KNIFE OR PICK. GOUGES OR GROOVES TO 0.25 INCHES DEEP CAN BE EXCAVATED BY HARD BLOW OF A GEOLOGIST'S PICK. HAND SPECIMENS CAN BE DETACHED BY MODERATE BLOWS.</p>																												
<p><b>MEDIUM HARD</b></p>	<p>CAN BE GROOVED OR GOUGED 0.05 INCHES DEEP BY FIRM PRESSURE OF KNIFE OR PICK POINT. CAN BE EXCAVATED IN SMALL CHIPS TO PIECES 1 INCH MAXIMUM SIZE BY HARD BLOWS OF THE POINT OF A GEOLOGIST'S PICK.</p>																												
<p><b>SOFT</b></p>	<p>CAN BE GROVED OR GOUGED READILY BY KNIFE OR PICK. CAN BE EXCAVATED IN FRAGMENTS FROM CHIPS TO SEVERAL INCHES IN SIZE BY MODERATE BLOWS OF A PICK POINT. SMALL, THIN PIECES CAN BE BROKEN BY FINGER PRESSURE.</p>																												
<p><b>VERY SOFT</b></p>	<p>CAN BE CARVED WITH KNIFE. CAN BE EXCAVATED READILY WITH POINT OF PICK. PIECES 1 INCH OR MORE IN THICKNESS CAN BE BROKEN BY FINGER PRESSURE. CAN BE SCRATCHED READILY BY FINGER NAIL.</p>																												
<p><b>FRACTURE SPACING</b></p> <table border="1"> <thead> <tr> <th>TERM</th> <th>SPACING</th> </tr> </thead> <tbody> <tr> <td>VERY WIDE</td> <td>MORE THAN 10 FEET</td> </tr> <tr> <td>WIDE</td> <td>3 TO 10 FEET</td> </tr> <tr> <td>MODERATELY CLOSE</td> <td>1 TO 3 FEET</td> </tr> <tr> <td>CLOSE</td> <td>0.16 TO 1 FEET</td> </tr> <tr> <td>VERY CLOSE</td> <td>LESS THAN 0.16 FEET</td> </tr> </tbody> </table>		TERM	SPACING	VERY WIDE	MORE THAN 10 FEET	WIDE	3 TO 10 FEET	MODERATELY CLOSE	1 TO 3 FEET	CLOSE	0.16 TO 1 FEET	VERY CLOSE	LESS THAN 0.16 FEET	<p><b>BEDDING</b></p> <table border="1"> <thead> <tr> <th>TERM</th> <th>THICKNESS</th> </tr> </thead> <tbody> <tr> <td>VERY THICKLY BEDDED</td> <td>&gt; 4 FEET</td> </tr> <tr> <td>THICKLY BEDDED</td> <td>1.5 - 4 FEET</td> </tr> <tr> <td>THINLY BEDDED</td> <td>0.16 - 1.5 FEET</td> </tr> <tr> <td>VERY THINLY BEDDED</td> <td>0.03 - 0.16 FEET</td> </tr> <tr> <td>THICKLY LAMINATED</td> <td>0.008 - 0.03 FEET</td> </tr> <tr> <td>THINLY LAMINATED</td> <td>&lt; 0.008 FEET</td> </tr> </tbody> </table>		TERM	THICKNESS	VERY THICKLY BEDDED	> 4 FEET	THICKLY BEDDED	1.5 - 4 FEET	THINLY BEDDED	0.16 - 1.5 FEET	VERY THINLY BEDDED	0.03 - 0.16 FEET	THICKLY LAMINATED	0.008 - 0.03 FEET	THINLY LAMINATED	< 0.008 FEET
TERM	SPACING																												
VERY WIDE	MORE THAN 10 FEET																												
WIDE	3 TO 10 FEET																												
MODERATELY CLOSE	1 TO 3 FEET																												
CLOSE	0.16 TO 1 FEET																												
VERY CLOSE	LESS THAN 0.16 FEET																												
TERM	THICKNESS																												
VERY THICKLY BEDDED	> 4 FEET																												
THICKLY BEDDED	1.5 - 4 FEET																												
THINLY BEDDED	0.16 - 1.5 FEET																												
VERY THINLY BEDDED	0.03 - 0.16 FEET																												
THICKLY LAMINATED	0.008 - 0.03 FEET																												
THINLY LAMINATED	< 0.008 FEET																												
<p><b>INDURATION</b></p> <p>FOR SEDIMENTARY ROCKS, INDURATION IS THE HARDENING OF THE MATERIAL BY CEMENTING, HEAT, PRESSURE, ETC.</p> <table border="1"> <tbody> <tr> <td>FRIABLE</td> <td>RUBBING WITH FINGER FREES NUMEROUS GRAINS; GENTLE BLOW BY HAMMER DISINTEGRATES SAMPLE.</td> </tr> <tr> <td>MODERATELY INDURATED</td> <td>GRAINS CAN BE SEPARATED FROM SAMPLE WITH STEEL PROBE; BREAKS EASILY WHEN HIT WITH HAMMER.</td> </tr> <tr> <td>INDURATED</td> <td>GRAINS ARE DIFFICULT TO SEPARATE WITH STEEL PROBE; DIFFICULT TO BREAK WITH HAMMER.</td> </tr> <tr> <td>EXTREMELY INDURATED</td> <td>SHARP HAMMER BLOWS REQUIRED TO BREAK SAMPLE; SAMPLE BREAKS ACROSS GRAINS.</td> </tr> </tbody> </table>				FRIABLE	RUBBING WITH FINGER FREES NUMEROUS GRAINS; GENTLE BLOW BY HAMMER DISINTEGRATES SAMPLE.	MODERATELY INDURATED	GRAINS CAN BE SEPARATED FROM SAMPLE WITH STEEL PROBE; BREAKS EASILY WHEN HIT WITH HAMMER.	INDURATED	GRAINS ARE DIFFICULT TO SEPARATE WITH STEEL PROBE; DIFFICULT TO BREAK WITH HAMMER.	EXTREMELY INDURATED	SHARP HAMMER BLOWS REQUIRED TO BREAK SAMPLE; SAMPLE BREAKS ACROSS GRAINS.																		
FRIABLE	RUBBING WITH FINGER FREES NUMEROUS GRAINS; GENTLE BLOW BY HAMMER DISINTEGRATES SAMPLE.																												
MODERATELY INDURATED	GRAINS CAN BE SEPARATED FROM SAMPLE WITH STEEL PROBE; BREAKS EASILY WHEN HIT WITH HAMMER.																												
INDURATED	GRAINS ARE DIFFICULT TO SEPARATE WITH STEEL PROBE; DIFFICULT TO BREAK WITH HAMMER.																												
EXTREMELY INDURATED	SHARP HAMMER BLOWS REQUIRED TO BREAK SAMPLE; SAMPLE BREAKS ACROSS GRAINS.																												
<p><b>BENCH MARK:</b> TBM-1, RAILROAD SPIKE IN 24' ELM TREE. ST I2+38, 37' RIGHT. N 975068, E 2650674</p>		<p align="right">ELEVATION: 5.23 FT.</p>																											
<p><b>NOTES:</b></p> <p>ADDITIONAL ABBREVIATIONS:</p> <p>CASREF - CASING REFUSAL</p> <p>FIAD - BORING FILLED IN AFTER DRILLING</p> <p>CV - CAVED</p>																													

<b>PROJECT REFERENCE NO.</b>	<b>SHEET</b>
17BP.1.R.15 (360012)	3
<b>SITE PLAN</b>	
FEET	

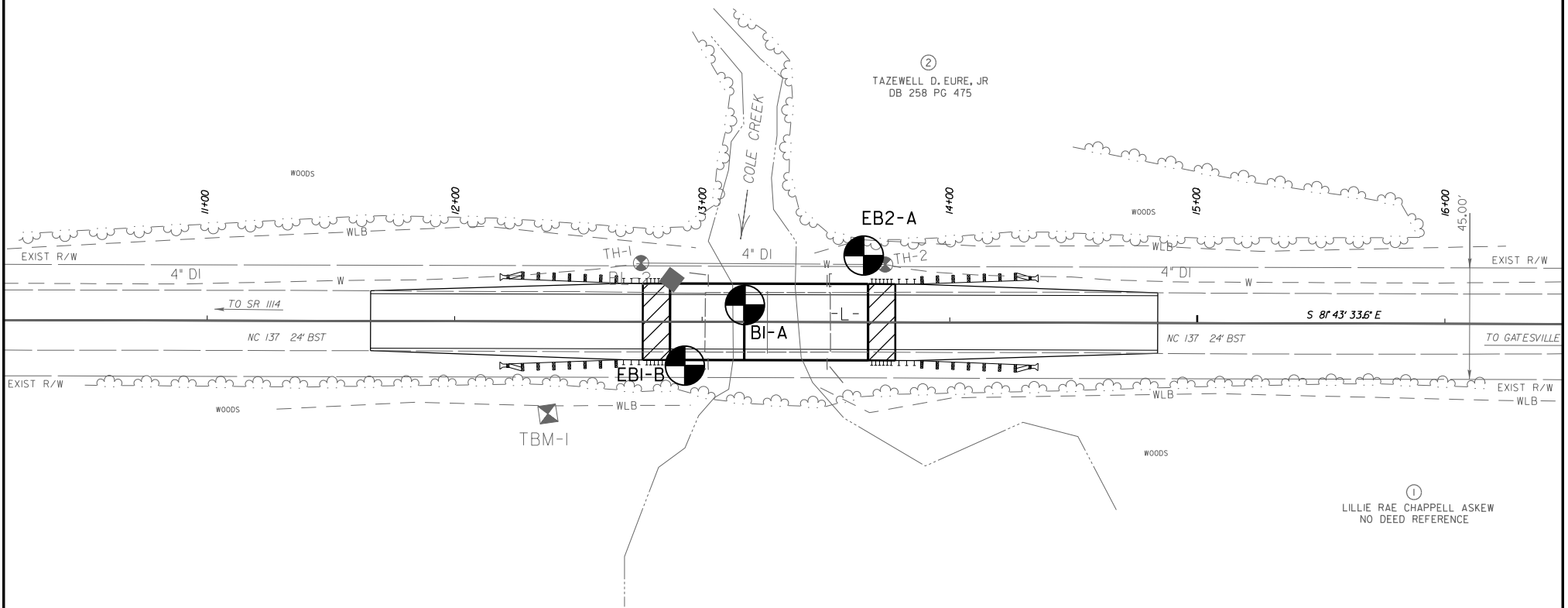
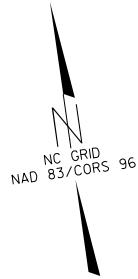

①  
LILLIE RAE CHAPPELL ASKEW  
NO DEED REFERENCE

BRIDGE #360012



# NCDOT GEOTECHNICAL ENGINEERING UNIT

## BORELOG REPORT

WBS 17BP.1.R.15		TIP 360012		COUNTY GATES		GEOLOGIST BACHMAN, M.										
SITE DESCRIPTION BRIDGE NO. 360012 ON NC HWY 137							GROUND WTR (ft)									
BORING NO. EB1-B		STATION 12+93		OFFSET 18 ft RT		ALIGNMENT -L-										
COLLAR ELEV. 9.0 ft		TOTAL DEPTH 90.0 ft		NORTHING 975,080		EASTING 2,650,732										
DRILL RIG/HAMMER EFF./DATE CME-55				DRILL METHOD Mud Rotary		HAMMER TYPE Automatic										
DRILLER WHICHARD, W		START DATE 04/04/12		COMP. DATE 04/04/12		SURFACE WATER DEPTH N/A										
ELEV (ft)	DRIVE ELEV (ft)	DEPTH (ft)	BLOW COUNT			BLOWS PER FOOT					SAMP. NO.	LOG MOI	SOIL AND ROCK DESCRIPTION	DEPTH (ft)		
			0.5ft	0.5ft	0.5ft	0	25	50	75	100						
10														9.0	GROUND SURFACE	0.0
5	8.0	1.0	1	1	1	2						SS-1	M	ROADWAY EMBANKMENT DARK BROWN AND GRAY, V. SOFT TO SOFT, F. SANDY SILTY CLAY (A-6) W/ WOOD FRAGMENTS		
	5.5	3.5	2	2	2	4						SS-2	M			
0	3.0	6.0	2	2	3	5						SS-3	W	ALLUVIAL TAN, V. LOOSE, F. TO MED. SAND (A-3)		
	0.5	8.5	WOH	WOH	WOH	7						SS-4	W			
-5	-4.5	13.5	6	4	3	7						SS-5	W	COASTAL PLAIN BLUE-GRAY, MED. STIFF, SILTY CLAY (A-6)	14.8	
-10	-9.5	18.5	2	3	4	7						SS-6	W			
-15	-14.5	23.5	3	4	7	11						SS-7	W	COASTAL PLAIN BLUE-GRAY, STIFF, SILTY CLAY (A-7)	22.0	
-20	-19.5	28.5	3	5	6	11						SS-8	W			
-25	-24.5	33.5	4	4	7	11						SS-9	W			
-30	-29.5	38.5	4	4	7	11						SS-10	W			
-35	-34.5	43.5	3	4	6	10						SS-11	W			
-40	-39.5	48.5	3	5	6	11						SS-12	W			
-45	-44.5	53.5	3	4	5	9						SS-13	W			
-50	-49.5	58.5	3	4	5	9						SS-14	W			
-55	-54.5	63.5	3	4	5	9						SS-15	W			
-60	-59.5	68.5	3	4	6	10						SS-16	W			
-65	-64.5	73.5	3	4	8	12						SS-17	W			
-70	-69.5	78.5														

NCDOT BORE SINGLE GATES\_GEO\_BRDG0012.GPJ NC\_DOT.GDT 7/6/12



# NCDOT GEOTECHNICAL ENGINEERING UNIT BORELOG REPORT

WBS 17BP.1.R.15	TIP 360012	COUNTY GATES	GEOLOGIST BACHMAN, M.
SITE DESCRIPTION BRIDGE NO. 360012 ON NC HWY 137			GROUND WTR (ft)
BORING NO. EB1-B	STATION 12+93	OFFSET 18 ft RT	ALIGNMENT -L-
COLLAR ELEV. 9.0 ft	TOTAL DEPTH 90.0 ft	NORTHING 975,080	EASTING 2,650,732
DRILL RIG/HAMMER EFF./DATE CME-55		DRILL METHOD Mud Rotary	HAMMER TYPE Automatic
DRILLER WHICHARD, W	START DATE 04/04/12	COMP. DATE 04/04/12	SURFACE WATER DEPTH N/A

ELEV (ft)	DRIVE ELEV (ft)	DEPTH (ft)	BLOW COUNT			BLOWS PER FOOT					SAMP. NO.	MOI	LOG	SOIL AND ROCK DESCRIPTION	DEPTH (ft)
			0.5ft	0.5ft	0.5ft	0	25	50	75	100					
-70						Match Line									
-75	-74.5	83.5	3	4	5	●					SS-18	W		<b>COASTAL PLAIN</b> BLUE-GRAY, STIFF, SILTY CLAY (A-7) <i>(continued)</i>	
-80	-79.5	88.5	3	4	6	●					SS-19	W			
-81.0	-79.5	88.5	3	3	5	●					SS-20	W			Boring Terminated at Elevation -81.0 ft IN CP: SILTY CLAY

NCDOT BORE SINGLE GATES\_GEO\_BRDG0012.GPJ NC\_DOT.GDT 7/6/12



# NCDOT GEOTECHNICAL ENGINEERING UNIT

## BORELOG REPORT

WBS 17BP.1.R.15	TIP 360012	COUNTY GATES	GEOLOGIST BACHMAN, M.
SITE DESCRIPTION BRIDGE NO. 360012 ON NC HWY 137			GROUND WTR (ft)
BORING NO. B1-A	STATION 13+17	OFFSET 7 ft RT	ALIGNMENT -L-
COLLAR ELEV. -0.1 ft	TOTAL DEPTH 105.3 ft	NORTHING 975,101	EASTING 2,650,759
DRILL RIG/HAMMER EFF./DATE CME-55		DRILL METHOD Mud Rotary	HAMMER TYPE Automatic
DRILLER WHICHARD, W	START DATE 04/11/12	COMP. DATE 04/11/12	SURFACE WATER DEPTH 2.0ft

ELEV (ft)	DRIVE ELEV (ft)	DEPTH (ft)	BLOW COUNT			BLOWS PER FOOT					SAMP. NO.	MOI	LOG	SOIL AND ROCK DESCRIPTION	DEPTH (ft)
			0.5ft	0.5ft	0.5ft	0	25	50	75	100					
0	-0.1	0.0	WOH	WOH	WOH									SOIL AND ROCK DESCRIPTION	
														WATER SURFACE (04/11/12)	
														GROUND SURFACE	0.0
											SS-1	W		ALLUVIAL DARK BROWN, V. SOFT, F. SANDY SILT (A-4)	3.0
-5	-3.9	3.8	3	6	6						SS-2	W		ALLUVIAL TAN, MED. DENSE, F. TO MED. SAND (A-3)	6.0
	-6.4	6.3	3	3	3						SS-3	W			
	-8.9	8.8	2	3	4						SS-4	W		COASTAL PLAIN BLUE-GRAY, MED. STIFF TO STIFF, SILTY CLAY (A-7) W/ SHELLS	
-10												W			
	-13.9	13.8	3	5	7						SS-5	W			
	-18.9	18.8	3	4	6						SS-6	W			
-20												W			
	-23.9	23.8	4	4	6						SS-7	W			
	-28.9	28.8	4	4	6						SS-8	W			
-30												W			
	-33.9	33.8	4	5	6						SS-9	W			
	-38.9	38.8	4	4	6						SS-10	W			
-40												W			
	-43.9	43.8	3	4	6						SS-11	W			
	-48.9	48.8	3	4	6						SS-12	W			
-50												W			
	-53.9	53.8	3	5	5						SS-13	W			
	-58.9	58.8	3	4	5						SS-14	W			
-60												W			
	-63.9	63.8	3	5	6						SS-15	W			
	-68.9	68.8	3	4	5						SS-16	W			
-70												W			
	-73.9	73.8	3	5	6						SS-17	W			
	-78.9	78.8	3	4	5						SS-18	W			

NCDOT BORE SINGLE GATES\_GEO\_BRDG0012.GPJ NC\_DOT.GDT 7/6/12



# NCDOT GEOTECHNICAL ENGINEERING UNIT BORELOG REPORT

WBS 17BP.1.R.15	TIP 360012	COUNTY GATES	GEOLOGIST BACHMAN, M.
SITE DESCRIPTION BRIDGE NO. 360012 ON NC HWY 137			GROUND WTR (ft)
BORING NO. B1-A	STATION 13+17	OFFSET 7 ft RT	ALIGNMENT -L-
COLLAR ELEV. -0.1 ft	TOTAL DEPTH 105.3 ft	NORTHING 975,101	EASTING 2,650,759
DRILL RIG/HAMMER EFF./DATE CME-55		DRILL METHOD Mud Rotary	HAMMER TYPE Automatic
DRILLER WHICHARD, W	START DATE 04/11/12	COMP. DATE 04/11/12	SURFACE WATER DEPTH 2.0ft

ELEV (ft)	DRIVE ELEV (ft)	DEPTH (ft)	BLOW COUNT			BLOWS PER FOOT					SAMP. NO.	MOI	LOG	SOIL AND ROCK DESCRIPTION	DEPTH (ft)
			0.5ft	0.5ft	0.5ft	0	25	50	75	100					
-80						Match Line									
-85	-83.9	83.8	3	4	5						SS-19	W		COASTAL PLAIN BLUE-GRAY, MED. STIFF TO STIFF, SILTY CLAY (A-7) W/ SHELLS (continued)	
-90	-88.9	88.8	3	4	5						SS-20	W			
-95	-93.9	93.8	WOH	2	6						SS-21	W			
-100	-98.9	98.8	1	3	3						SS-22	W		-98.1	98.0
-105	-103.9	103.8	1	3	5						SS-23	W		-105.4	105.3
														Boring Terminated at Elevation -105.4 ft IN CP: CLAYEY F. SAND	

NCDOT BORE SINGLE GATES\_GEO\_BRDG0012.GPJ NC\_DOT.GDT 7/6/12





# NCDOT GEOTECHNICAL ENGINEERING UNIT

## BORELOG REPORT

WBS 17BP.1.R.15		TIP 360012		COUNTY GATES		GEOLOGIST BACHMAN, M.											
SITE DESCRIPTION BRIDGE NO. 360012 ON NC HWY 137							GROUND WTR (ft)										
BORING NO. EB2-A		STATION 13+65		OFFSET 27 ft RT		ALIGNMENT -L-											
COLLAR ELEV. 9.2 ft		TOTAL DEPTH 90.0 ft		NORTHING 975,113		EASTING 2,650,810											
DRILL RIG/HAMMER EFF./DATE CME-55				DRILL METHOD Mud Rotary		HAMMER TYPE Automatic											
DRILLER WHICHARD, W.		START DATE 04/05/12		COMP. DATE 04/05/12		SURFACE WATER DEPTH N/A											
ELEV (ft)	DRIVE ELEV (ft)	DEPTH (ft)	BLOW COUNT			BLOWS PER FOOT					SAMP. NO.	MOI	LOG	SOIL AND ROCK DESCRIPTION	DEPTH (ft)		
			0.5ft	0.5ft	0.5ft	0	25	50	75	100						ELEV. (ft)	
10															9.2	GROUND SURFACE	0.0
5	8.2	1.0	3	3	4											<b>ROADWAY EMBANKMENT</b> TAN, BROWN, AND ORANGE, LOOSE TO V. LOOSE, SILTY CLAYEY F. TO MED. SAND (A-2-6)	
	5.7	3.5	2	1	2												
0	3.2	6.0	WOH	1	1											<b>ALLUVIAL</b> DARK BROWN, V. SOFT, SANDY SILTY CLAY (A-6) W/ WOOD FRAGMENTS	7.2
	0.7	8.5	WOH	WOH	1												
-5	-4.4	13.5	6	5	2											<b>ALLUVIAL</b> GRAY, LOOSE, CLAYEY F. TO MED. SAND (A-2-6)	13.0
-10	-9.4	18.5	2	3	4											<b>COASTAL PLAIN</b> BLUE-GRAY, MED. STIFF, SILTY CLAY (A-6)	16.0
-15	-14.4	23.5	4	4	7												26.0
-20	-19.4	28.5	3	5	7											<b>COASTAL PLAIN</b> BLUE-GRAY, STIFF, SILTY CLAY (A-7) W/ SHELLS	
-25	-24.4	33.5	4	5	7												
-30	-29.4	38.5	3	5	6												
-35	-34.4	43.5	4	4	7												
-40	-39.4	48.5	3	4	5												
-45	-44.4	53.5	3	4	5												
-50	-49.4	58.5	3	4	4												
-55	-54.4	63.5	3	4	6												
-60	-59.4	68.5	3	4	5												
-65	-64.4	73.5	3	4	5												
-70	-69.4	78.5															

NCDOT BORE SINGLE GATES\_GEO\_BRDG0012.GPJ NC\_DOT.GDT 7/6/12



# NCDOT GEOTECHNICAL ENGINEERING UNIT

## BORELOG REPORT

WBS 17BP.1.R.15		TIP 360012		COUNTY GATES		GEOLOGIST BACHMAN, M.											
SITE DESCRIPTION BRIDGE NO. 360012 ON NC HWY 137							GROUND WTR (ft)										
BORING NO. EB2-A		STATION 13+65		OFFSET 27 ft RT		ALIGNMENT -L-											
COLLAR ELEV. 9.2 ft		TOTAL DEPTH 90.0 ft		NORTHING 975,113		EASTING 2,650,810											
DRILL RIG/HAMMER EFF./DATE CME-55				DRILL METHOD Mud Rotary		HAMMER TYPE Automatic											
DRILLER WHICHARD, W.		START DATE 04/05/12		COMP. DATE 04/05/12		SURFACE WATER DEPTH N/A											
ELEV (ft)	DRIVE ELEV (ft)	DEPTH (ft)	BLOW COUNT			BLOWS PER FOOT					SAMP. NO.	MOI	LOG	SOIL AND ROCK DESCRIPTION	DEPTH (ft)		
			0.5ft	0.5ft	0.5ft	0	25	50	75	100						ELEV. (ft)	
-70			3	4	5	Match Line					SS-18	W		<b>COASTAL PLAIN</b> BLUE-GRAY, STIFF, SILTY CLAY (A-7) W/ SHELLS (continued)			
-75	-74.4	83.5	3	4	6	●	●	●	●	●	SS-19	W					
-80	-79.4	88.5	3	4	6	●	●	●	●	●	SS-20	W					
															-80.9	90.0	Boring Terminated at Elevation -80.9 ft IN CP: SILTY CLAY